



How to Remove the Stand on a PlayStation 5

Follow this guide to remove the stand on a...

Written By: Robert Boyd



INTRODUCTION

Follow this guide to remove the stand on a PlayStation 5.

Before you begin, completely **power down and unplug all cables** from your console. Remember to follow general electrostatic discharge (ESD) safety procedures while repairing the console.



TOOLS:

- [Flathead 3/32" or 2.5 mm Screwdriver](#) (1)
- [Coin](#) (1)

optional

Step 1 — Remove the stand screw



- If your PlayStation 5 is in its vertical orientation, flip it upside down so the stand is facing up.
- ⓘ If your PlayStation 5 is in its horizontal orientation, skip to Step 6.
- ⚠ Work on a flat surface to prevent your PlayStation from falling over.
- Use a coin or a flathead screwdriver to remove the 26.5 mm-long stand screw.

Step 2 — Remove the vertical stand



- Lift straight up to remove the stand.

Step 3 — Store the stand screw



- Insert the screw into the cubby on the bottom of the stand.

Step 4 — Cap the screw hole



- Use a pair of tweezers or your fingernail to remove the cap from the cubby.
- Use your finger to press the cap into the screw hole.

Step 5 — Close the cubby



- Twist the stand counterclockwise to close the cubby.

Step 6 — Remove the horizontal stand

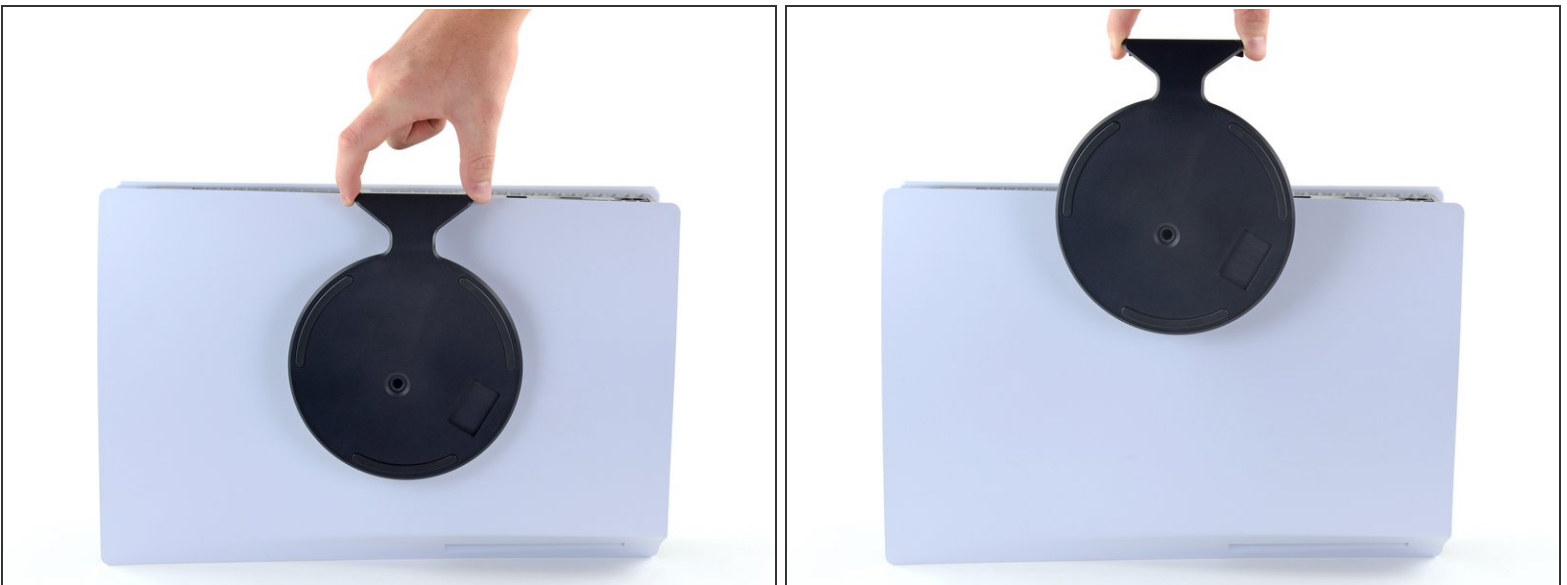

- If your PlayStation 5 is in its horizontal orientation, rest it on its face with the charging port facing up.
- Lift the stand straight up to remove it.

To reassemble your device, follow these instructions in reverse order.

Take your e-waste to an [R2 or e-Stewards certified recycler](#).

Repair didn't go as planned? Try some [basic troubleshooting](#), or ask our [PlayStation 5 Answers community](#) for help.