



# How to Mend Broken China

How to effectively mend broken china.

Written By: Mikkeline Thomsen



## INTRODUCTION

China is delicate and will often break due to daily use and careless handling. This guide will show you how to effectively mend plain, slightly broken china using a clear epoxy filler.

Tip: You can add any pigment to the epoxy, making the cracks less visible and the repair more subtle.



### TOOLS:

- [Razor Blade](#) (1)
  - [Tweezers](#) (1)
  - [Toothpicks](#) (1)
  - [Container filled with gravel or sand](#) (1)
  - [Epoxy](#) (1)
  - [Sand Paper](#) (1)
  - [Isopropyl Alcohol](#) (1)
-

## Step 1 — How to Mend Broken China



- Wipe all broken edges with rubbing alcohol using a paper towel.
- ⓘ Do this to eliminate any grease and dirt.
- ⚠ Be aware that rubbing alcohol is highly flammable.
- ⚠ Be aware of sharp edges throughout this repair.

## Step 2



- Pour epoxy into a smooth-surfaced container.
- ⓘ We used the plastic wrapping of the razor, but any container works.
- ⚠ Don't use epoxy in a small, confined space.
- ⚠ Do not get epoxy near eyes or on skin. Consider using polyethylene or polypropylene gloves.

### Step 3

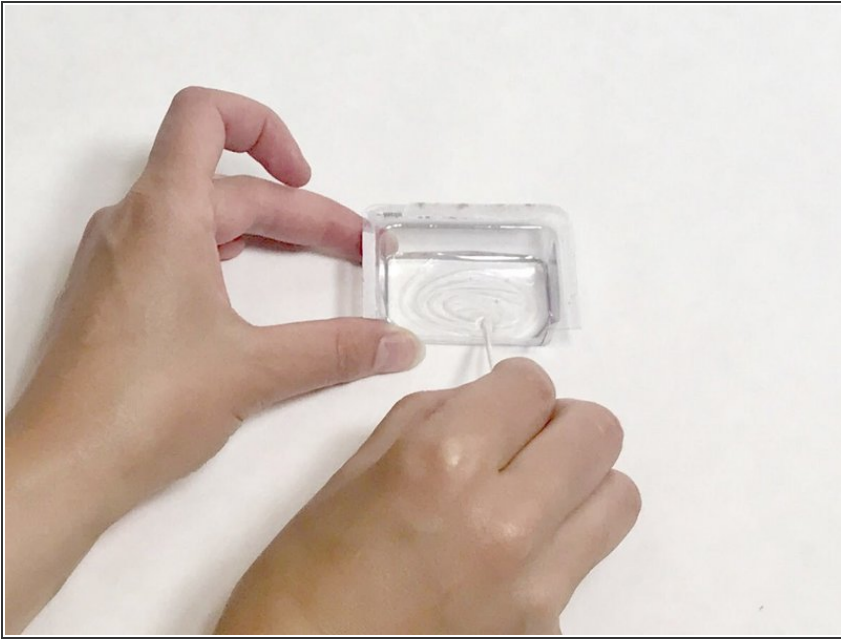

- Mix epoxy fluids with a toothpick.
- ⓘ The fluid sets in 5 minutes, so you must quickly apply it to the china. You can mix more if the first pour hardens.

### Step 4



- Apply the epoxy along the edges of the base piece of china and first chipped piece of china using the toothpick.



## Step 5



- Attach the first detached piece to the base carefully by hand.
  - Adjust as needed.
- i** Don't worry about excess epoxy at this point. It will be removed after setting.

## Step 6

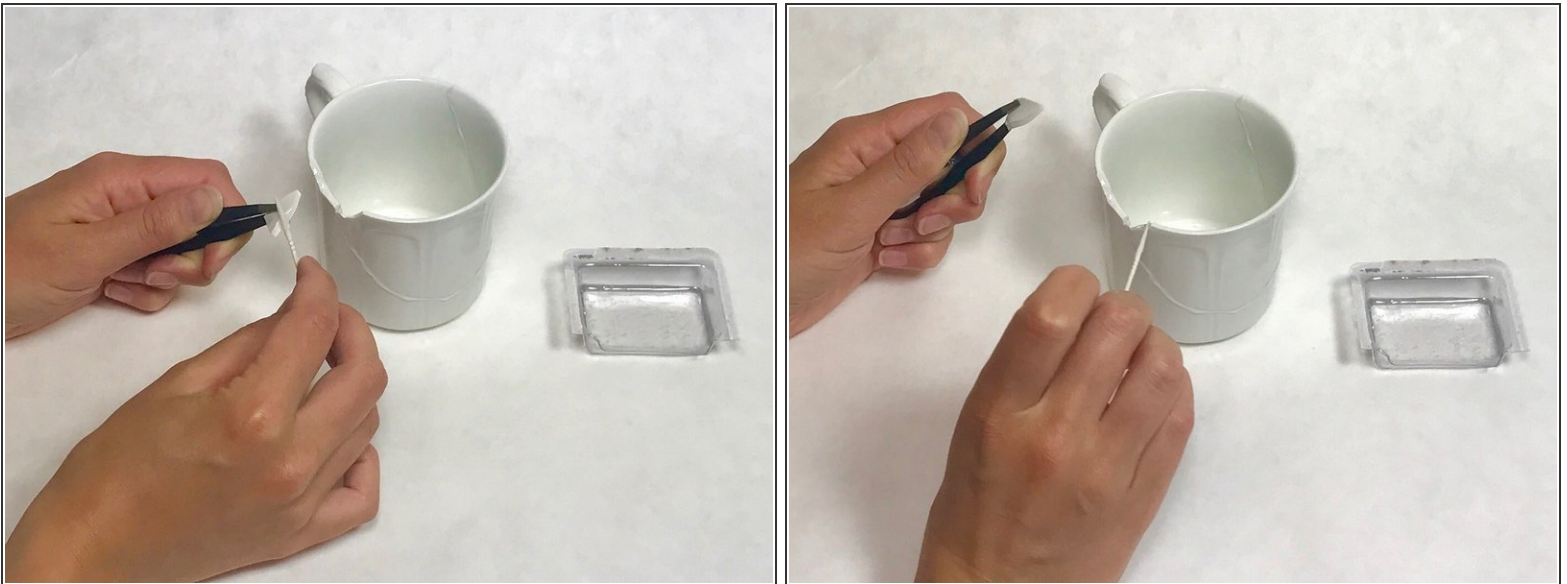

- Apply epoxy on the next detached piece and the already mended piece
- i** Use a tweezer to attach smaller fragments.

## Step 7

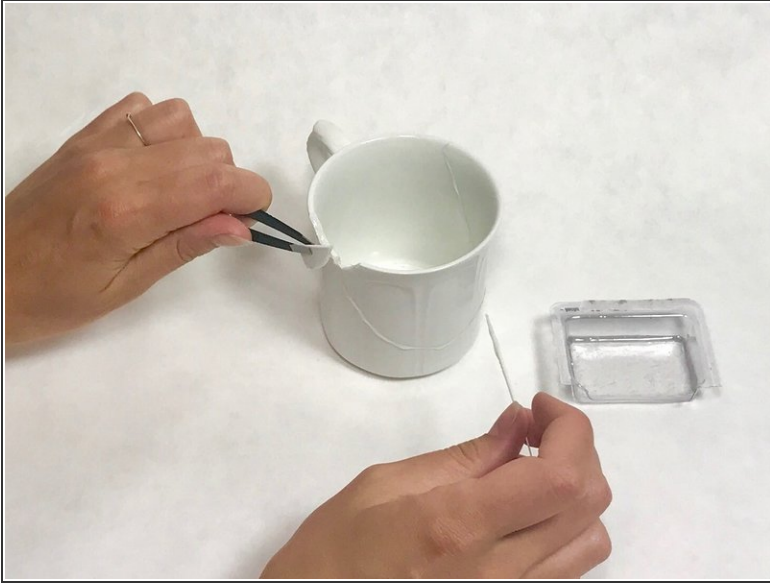

- Attach the piece to the china.
- Adjust as needed
- Repeat the process of applying epoxy and attaching the chips until all broken pieces are successfully in place.

## Step 8

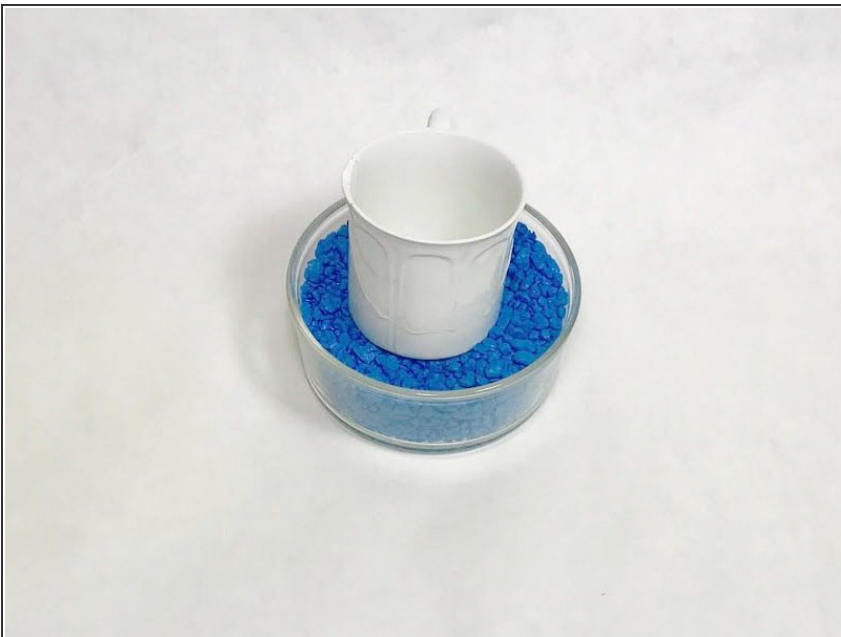

- Place mended china in a container of stabilizing sand or gravel.
- ⓘ This step is performed to put the right gravitational weight on the attachments so the pieces don't become unaligned during the setting of the epoxy.
- ⓘ Leave to set for at least 1 hour.



## Step 9



- Shave off as much excess epoxy as possible using the razor.

⚠ Exhibit caution when using the razors; they are very sharp!

## Step 10



- Use coarse sandpaper to further reduce the excess epoxy.

## Step 11



- Use fine sandpaper to smooth out remaining inconsistencies.

## Step 12



- ❗ Darker cracks form where the clear epoxy functions as filler, but the cup will work perfectly fine! Add colored pigment to the epoxy for a more subtle repair.