

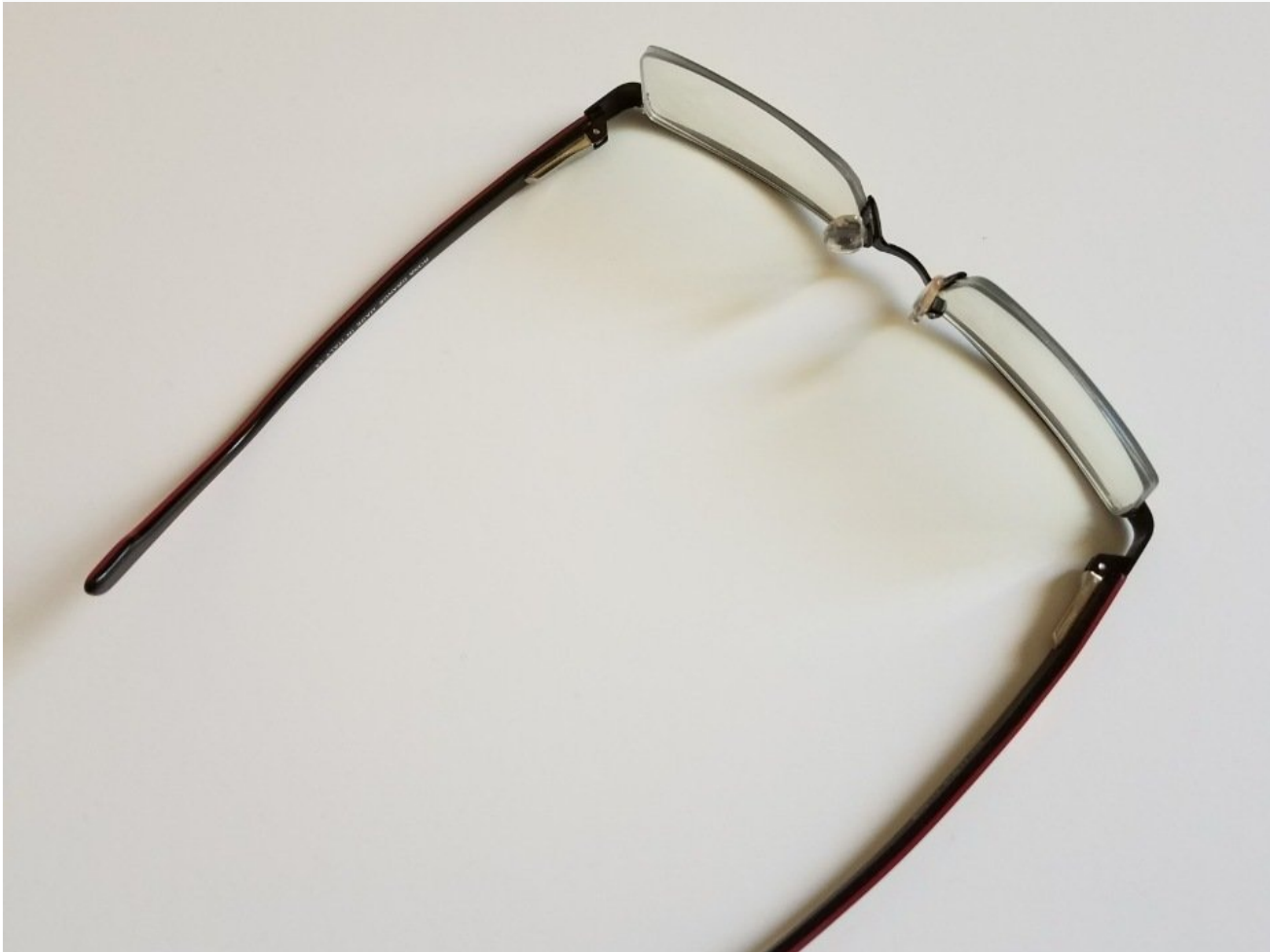

How to Fix Semi-Rimless Glasses

Use this guide to repair semi-rimless glasses...

Written By: Sabina Paneru



INTRODUCTION

Use this guide to repair semi-rimless glasses with a broken or loose retaining thread or lenses that have come out of the spectacles. This is a quick, simple repair. It can be done at home easily with tools like tweezers, fishing thread (as per the glass hole size), nail cutters, and scissors.

TOOLS:

[Tweezers](#) (1)
[Scissors](#) (1)
[Flush Cutter](#) (1)

PARTS:

[Monofilament Line](#) (1)

Step 1 — Monofilament Lens Retainer



- Inspect frame to make certain the Monofilament Lens Retainer is broken. If the wire is not broken, your lens has fallen out and can easily be re-inserted. If the wire is broken refer to the following steps.

Step 2

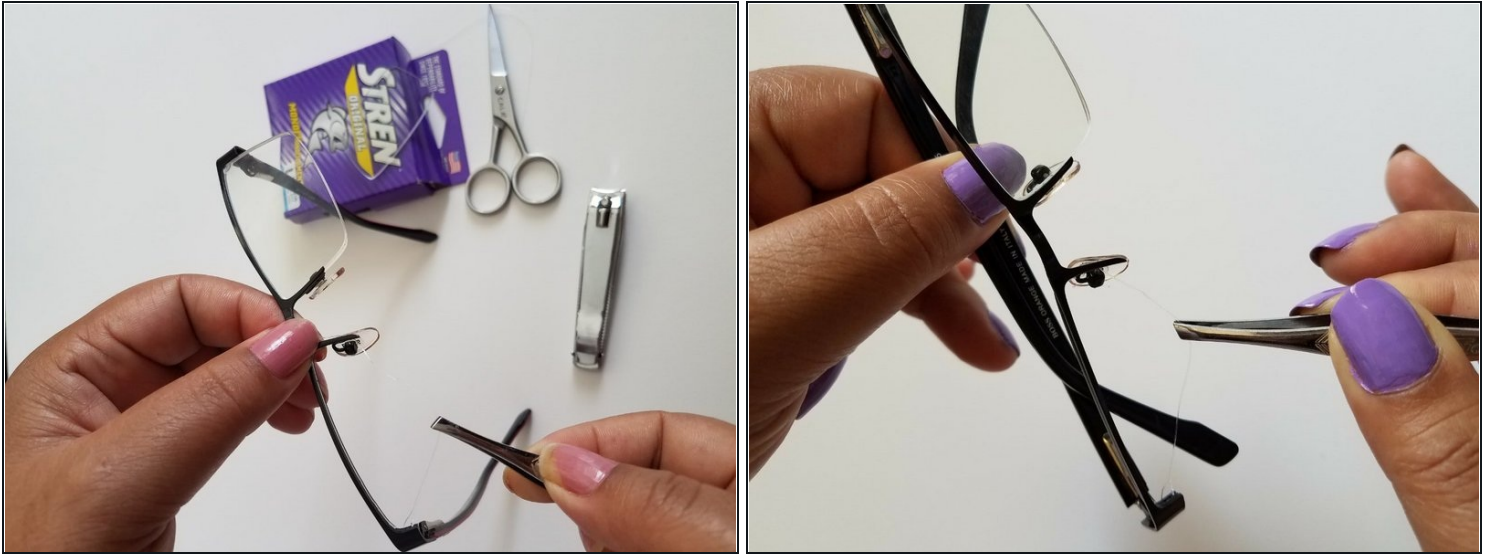

- Remove the old wire/string from the spectacles using the [tweezers](#) as shown in the pictures to the right.

Step 3



- Cut the new fishing wire between 7 and 9 inches.

Step 4



- Hold the glasses in the position shown in the image. There will be a hole near the nose pad, shown by the arrow in the second photo, you will use this to insert the new wire.

Step 5



- Insert one end of the wire into the hole near the pad arm and insert the other end to the opposite side of the glasses, then tie the knot as shown in the images.

Step 6

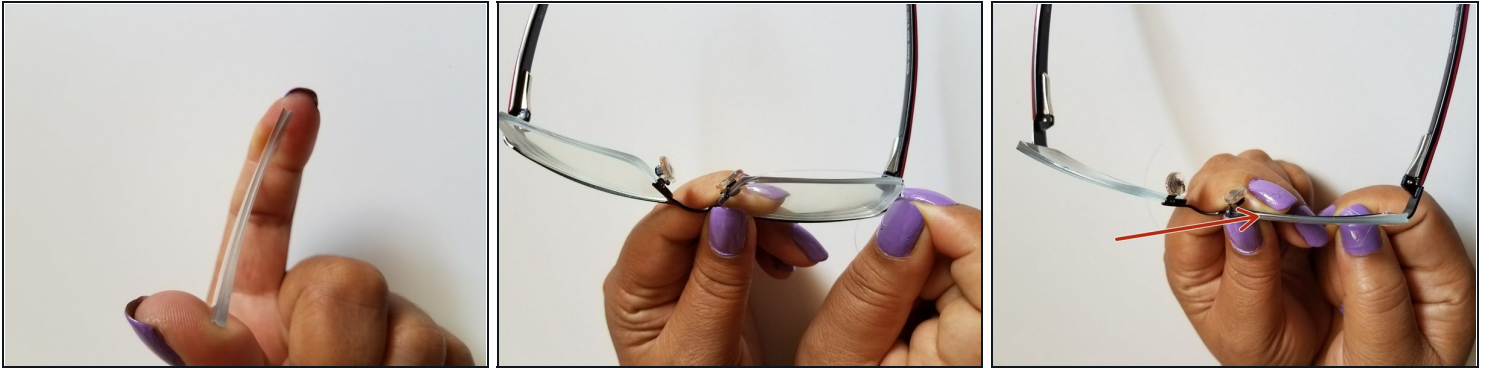

- You will see a thin groove along the edge of the glasses. Carefully fix the wire around the groove as shown in the pictures.

Step 7



- After placing the wire around the glasses, stretch the wire, tie it, and make a knot by holding the glasses tightly.
- ⓘ Do not tie a knot at the end of wire, but at the location where the wire is holding the glasses tightly.

Step 8



- Now, cut the extra wire from both sides of the glasses using the nail cutter.
 - ① Use of scissors might make it difficult to cut extra wire. So, we suggest you use nail cutter to cut extra wire.
- ⚠ Pay extra attention while cutting a wire, as you might cut more than needed and loosen it, which could lead you to start over.

Step 9

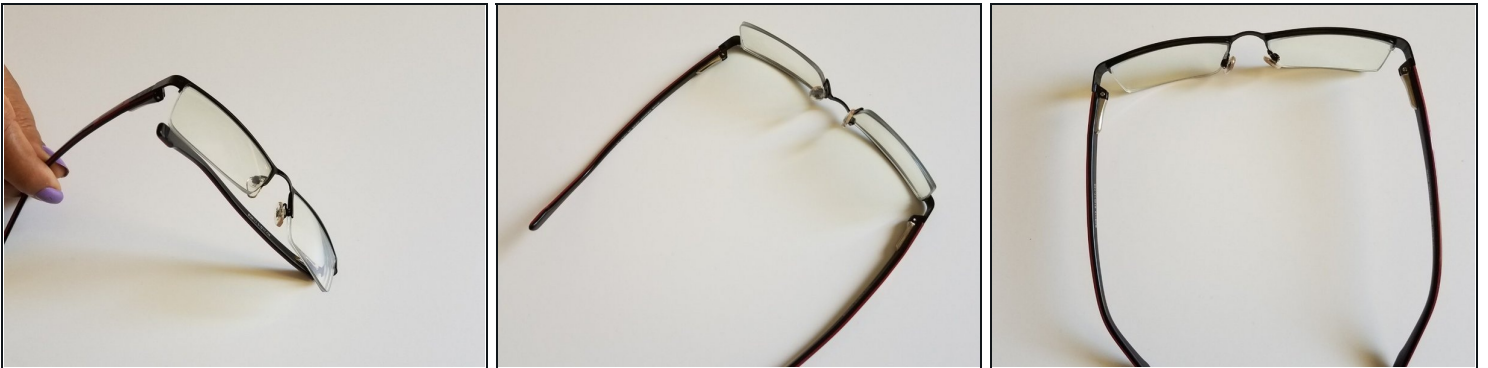

- In the end, check if your glasses are tight enough to wear. If the glasses are tight, they are ready to wear.

To reassemble your device, follow these instructions in reverse order.